

Hau'pal

O'otham word for *red tail hawk*

The red tail hawk was selected to be the namesake of the healthcare facility because of the bird's cultural significance and symbolism to the Gila River Indian Community and other Native American tribes. The idea of the hau'pal or red tail hawk originated from the location, as Hau'pal Health Center is nestled in GRIC's District 4 along the northern boundary of the Community and near Queen Creek and Old Price Roads. Of the many GRIC cultural stories that exist, one is about the red tail hawk, known as a guardian of the northern border. It is traditionally held in high honor by Gila River Indian Community members, spiritualists, and traditional healers, and is used in ceremonial practices and blessings. At the groundbreaking ceremony, the feathers of the hau'pal were used as part of the traditional prayer. Those in attendance witnessed a hau'pal fly by during the prayer thereby reaffirming the name, Hau'pal, by the Creator. The shegoi carried by the hau'pal is symbolic of the GRIC belief in its medicinal properties. The colorful shegoi flowers are a significant element within the GRHC brand.



The Gila River Indian Community is the largest Native American Community in the Phoenix area and is home to the Akimel O'otham (Pima) and the Pee Posh (Maricopa). The Pee Posh came from the area around Yuma to become an ally of the Akimel O'otham, standing together against warring enemies. Although each group preserved its own traditions, they agreed that a single council would govern their affairs. Today they live compatibly in the Gila River Indian Community.



GRHC.ORG



GRHC.ORG/haupal





Hau'pal
RED TAIL HAWK
HEALTH CENTER



Sapkam Ki'

O'otham words for house to heal or get well

For many years, it has been a dream of our elders to establish a healthcare system that reflects the unique cultural, spiritual, and health needs of our people. The Hau'pal Health Center reflects the transformation and growth of Gila River Health Care. Upon arrival at the Sapkam Ki' or Hau'pal Health Center, patients will be greeted with respectful and compassionate care.

3. O'las Ki'

O'otham word for round house

A traditional Pima house, or olas ki', was significant to the culture. It was a single room where families gathered to eat and sleep; in essence, families were kept close within the "circle."

Upon entering the Hau'pal Health Center, one will experience the foyer which includes a circular ceiling and circular terrazzo floor pattern. Circles are strong symbols among many Native Americans, and Gila River Health Care understands the importance of this symbolism, working in unity with families to keep patients at the center of everything we do.

1. Hau'pal Ki'

O'otham words for house of the red tail hawk

The Hau'pal Ki' is the red, rectangular structure located on the east side of the main entrance. This structure is dedicated to the hau'pal that is frequently seen roaming the skies of the northern boundary of the GRIC.

The Hau'pal Ki' is red in color and amplifies the hau'pal message of working to heal wounds while keeping a strong sense of belonging.

Red tail hawks are commonly seen near the new facility, and help call your attention to something important.

Shegoi

O'otham word for greasewood shrub

The greasewood shrub is known to the Gila River Indian Community as the shegoi. The powerful properties of the shegoi are used in both the lives and ceremonies of the Gila River Indian Community.

Culturally, shegoi is used for medicinal purposes, traditional blessings, and healing prayers. The shegoi symbol is prominent for Gila River Health Care and is a major brand element in the corporate logo. It is also an inter-connecting brand element as a shegoi twig is carried in the beak of the hau'pal in what is the new logo for Hau'pal Health Center.

4. Schudag

O'otham word for water

To the people of the Gila River Indian Community, water is sacred because of its importance to life. The Gila River was the most prominent river of many rivers merging together and was the water source for members of the GRIC to sustain their lives in earlier years.

To honor and symbolize the importance of water, you can see the terrazzo flooring patterned after the Gila River flowing from east to west. Also of significance is that the Gila River connects all 7 districts of the GRIC.

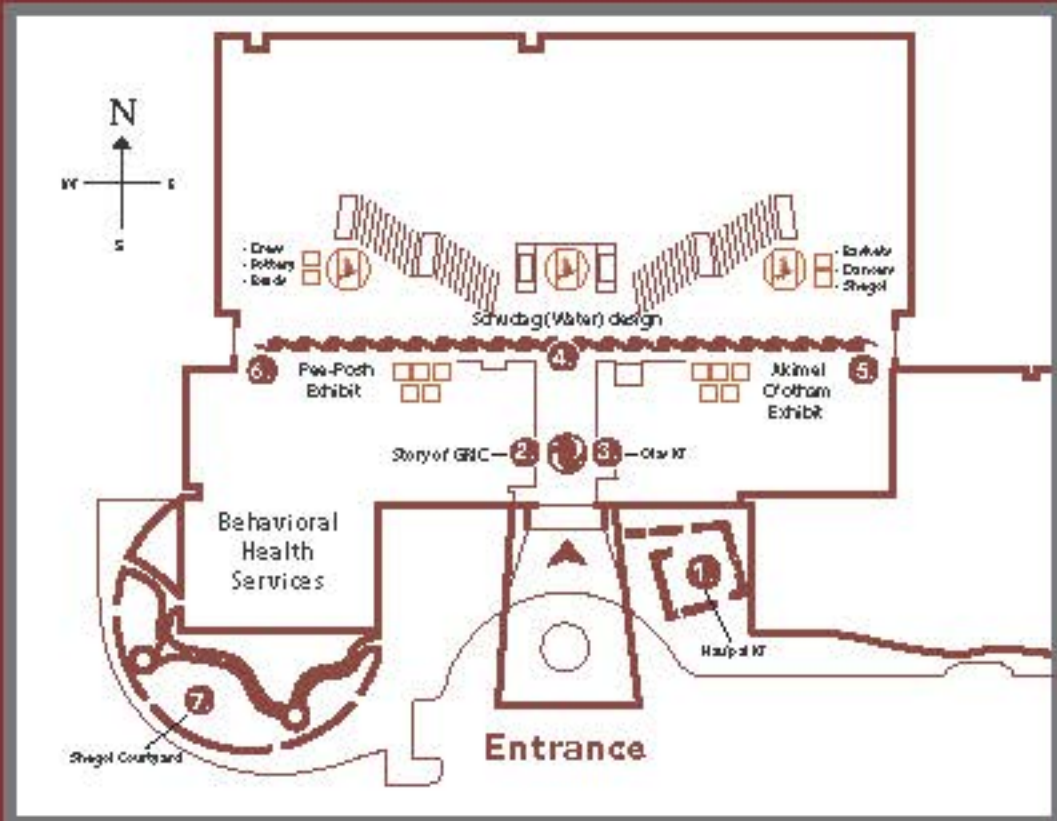

Cultural Points of Pride

- | | | |
|--|---------------------------|------------------------|
| 1. Hau'pal Ki' (Red Tail Hawk House) | 4. Schudag (Water) design | 6. Pee-Posh (Maricopa) |
| 2. Gila River Indian Community description | 5. Akimel O'otham (Pima) | - Bird Dance & |
| 3. O'las Ki' (Round House) | - Basket Dance & | - Pottery |
| | - Shegoi | 7. Shegoi Courtyard |

